

# SINGER

MACHINES 281-1, 281-3 AND 281-21

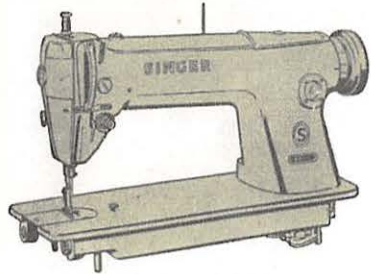
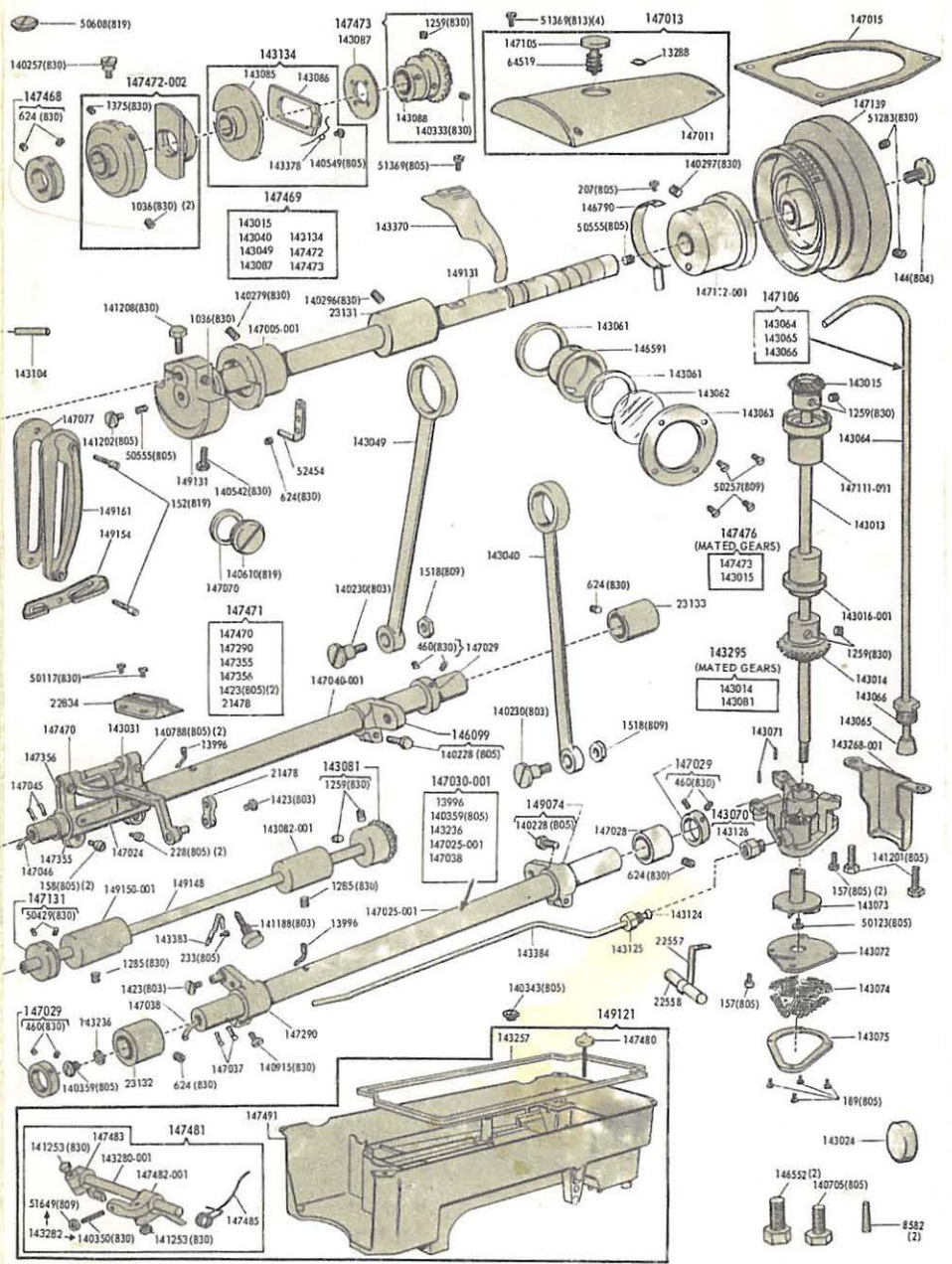
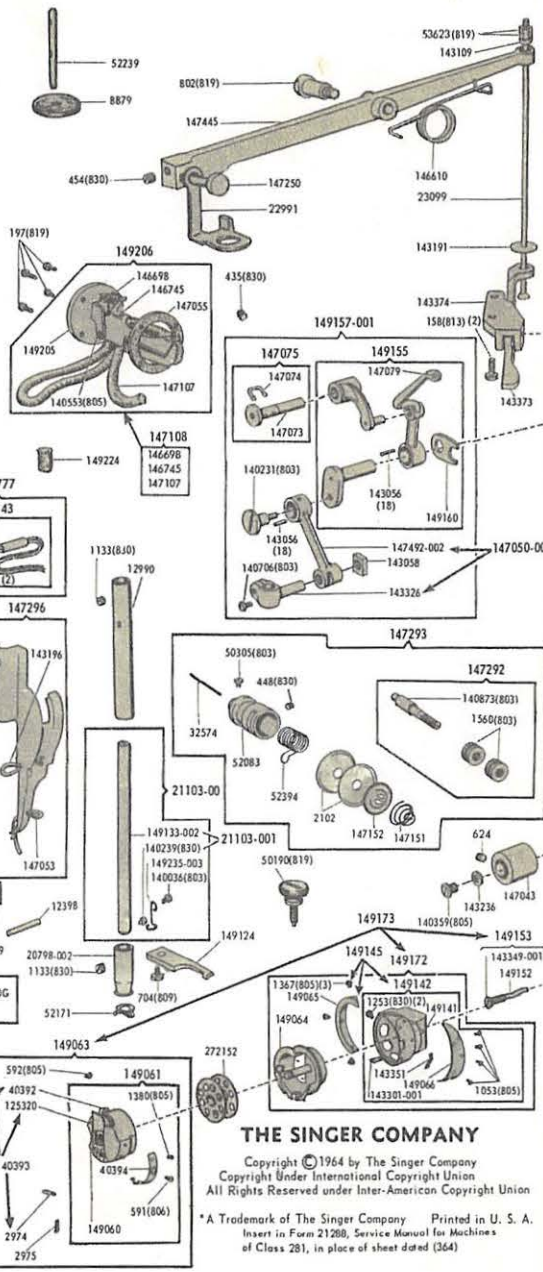
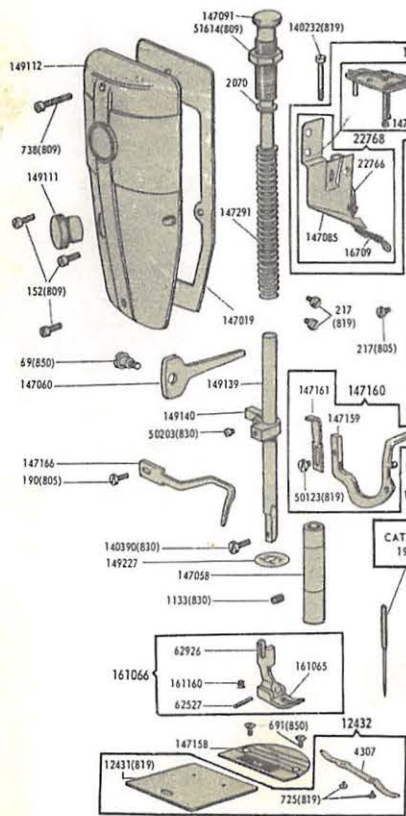

ILLUSTRATION OF  
281-1 PARTS



### THE SINGER COMPANY

Copyright © 1964 by The Singer Company  
Copyright Under International Copyright Union  
All Rights Reserved under Inter-American Copyright Union  
\* A Trademark of The Singer Company Printed in U. S. A.  
Insert in Form 21208, Service Manual for Machines  
of Class 281, in place of sheet dated (364)

# NUMERICAL LIST OF PARTS, MACHINE 281-1

PART NO.	DESCRIPTION	PART NO.	DESCRIPTION	PART NO.	DESCRIPTION
69(850)	Presser Bar Lifter Hinge Screw	13996	Feed Lifting Rock Shaft Oil Wick	140607(819)	Arm Top Cover Stitch Regulator
141(804)	Arm Shaft (horizontal) Screw (back)	16709	Arm Side Shield Wick Spring Holder		Plunger Hole Plug Screw, for plugging
152(809)	Face Plate Screw (lower) (3)	20798-002	Needle Bar Bushing (lower)		the Plunger Hole when the Plunger is
152(819)	Thread Take-up Lever Guard and	21103-001	Needle Bar (bottle) complete, Nos.		removed to prevent tampering with
	Thread Eyelet and Thread Guard		140036(803), 149133-002 and		the stitch set (for Agents only)
	Screw (front of Arm)		149235-003	140610(819)	Thread Take-up Crank Clamping
152(819)	Thread Take-up Lever Guard	21478	Feed Bar Connecting Link		Screw Hole Plug Screw
	Screw (upper)	22557	Magnet (for removing iron particles	140705(805)	Arm Screw (back)
157(805)	Oil Pump (centrifugal) Body Screw (2)		from oil)	140706(803)	Needle Bar Connecting Stud Clamp-
157(805)	Magnet Retaining Clamp and Oil	22558	Magnet Retaining Clamp		ing Screw
	Pump (centrifugal) Body Screw			140788(805)	Feed Bar Hinge Pin Clamping Screw
158(805)	Feed Bar Carrier Clamping Screw (2)	22766	Arm Side Shield Wick		(2)
158(813)	Bell Crank Bracket Screw (2)	22768	Arm Side Shield complete, Nos.	140873(803)	Tension Stud
189(805)	Oil Pump (centrifugal) Screen Frame		16709, 22766 and 147085	140915(830)	Feed Lifting Rock Shaft Crank (front)
	Screw (4)	22777	Arm Side Shield and Oil Wick Holder		Clamping Screw
190(805)	Slack Thread Regulator Screw		Nos. 22768 and 147143	141188(803)	Rotating Hook Oil Flow Regulating
197(819)	Oil Removing Wick (head end) Hinge	22834	Feed Dog, (20 teeth to the inch),		Thumb Screw
	Plate and Cover Screw (4)		for use with 147158 and 161066	141201(805)	Arm and Bed Leg (back) Screw (2)
207(805)	Arm Shaft (horizontal) Flanged	22991	Presser Bar Lifting Lever Link	141202(805)	Arm Shaft (horizontal) Screw Plug
	Bushing (back) Oil Sump Tube Holder	23099	Presser Bar Lifting Lever Connecting		(front)
	Screw		Rod	141208(830)	Thread Take-up Crank Clamping
217(805)	Thread Take-up Lever Oil Guard	23131	Arm Shaft (horizontal) Bushing		Screw
	Screw		(center)	141253(830)	Rock Shaft Crank Clamping Screw (2)
217(819)	Arm Side Shield Screw (2)	23132	Feed Lifting Rock Shaft Bushing (2)	143013	Arm Shaft (upright)
228(805)	Feed Bar Carrier Oil Wick Holder	23133	Feed Rock Shaft Bushing (back)	143014	Arm Shaft (upright) Bevel Gear
	Screw (2)	23134	Feed Rock Shaft Bushing (front)		(lower) right hand spiral with two
233(805)	Rotating Hook Oil Flow Regulating	32574	Tension Releasing Pin	1259(830)	
	Thumb Screw Spring Screw	40392	Rotating Hook Bobbin Case Latch	143015	Arm Shaft (upright) Bevel Gear
435(830)	Thread Take-up Lever Link Hinge	40393	Rotating Hook Bobbin Case Latch		(upper) left hand spiral with two
	Stud Set Screw		Hinge, Nos. 2974, 40392 and 125320	143016-001	Arm Shaft (upright) Bushing (lower)
448(830)	Thread Take-up Spring Regulator	40394	(for Agents only)	143024	Bed Hole Plug
	Set Screw		Rotating Hook Bobbin Case Tension	143031	Feed Bar Carrier Oil Wick
454(830)	Presser Bar Lifting Lever Pin Set		Spring	143040	Feed Lifting Rock Shaft Connecting
	Screw		Feed Dog Screw (2)		Rod
460(830)	Feed Lifting Rock Shaft Collar Set	50117(830)	Oil Pump (centrifugal) Impeller	143049	Feed Rock Shaft Connecting Rod
	Screw (4)	50123(805)	Locking Screw	143056	Thread Take-up Lever Roller
460(830)	Feed Rock Shaft Collar Set Screw(2)	50123(819)	Tension Releasing Lever (adjustable)	143056	Bearing (18)
591(806)	Rotating Hook Bobbin Case Tension	50190(819)	Screw	143058	Needle Bar Connecting Link Roller
	Regulating Screw	50203(830)	Guide Thumb Screw		Bearing (18)
592(805)	Rotating Hook Bobbin Case Latch	50257(809)	Presser Bar Guide Bracket Clamp-	143058	Needle Bar Connecting Stud Slide
	Stop Screw	50305(803)	ing Screw		Block
624(830)	Arm Shaft (horizontal) Thrust Collar	50429(830)	Oil Flow Window Cap Screw (4)	143061	Oil Flow Body Gasket (2)
	(front) Set Screw (2)	50555(805)	Tension Stud Set Screw	143062	Oil Flow Window
624(830)	Feed Lifting Rock Shaft Bushing	50608(819)	Rotating Hook Shaft Oil Retaining	143063	Oil Flow Window Cap
	(back and front) Set Screw (2)		Collar Set Screw (2)	143064	Oil Pipe for 147106
624(830)	Feed Rock Shaft Bushing (back) Set	51283(830)	Arm Shaft (horizontal) Plug Screw (2)	143065	Oil Pipe Clamping Sleeve
	Screw	51369(805)	Arm Hole Plug Screw (top of Arm)	143066	Oil Pipe Clamping Sleeve Nut
624(830)	Feed Rock Shaft Bushing (front) Set	51614(809)	for plugging hole used to assemble	143070	Oil Pump (centrifugal) Body with 143126
	Screw		take-up oil wicks	143071	Oil Pump (centrifugal) Body Position
624(830)	Thread Retainer Set Screw	51649(809)	Machine Pulley Set Screw (2)		Pin (2)
691(850)	Throat Plate Screw (2)	52083	Oil Lead Screw	143072	Oil Pump (centrifugal) Cover
704(809)	Rotating Hook Bobbin Case Holder	52171	Arm Top Cover Screw (4)	143073	Oil Pump (centrifugal) Impeller
	Position Bracket Screw	52239	Pressure Regulating Thumb Screw	143074	Oil Pump (centrifugal) Screen
725(819)	Bed Slide Spring Screw (2)	52394	Lock Nut	143075	Oil Pump (centrifugal) Screen Frame
738(809)	Face Plate Screw (upper)	52454	Rock Shaft Crank Adjusting Screw	143081	Rotating Hook Shaft Bevel Gear (left
802(819)	Presser Bar Lifting Lever Hinge	53623(819)	Lock Nut		hand spiral) with two 1259(830)
	Screw	62527	Thread Take-up Spring Regulator	143082-001	Rotating Hook Shaft Bushing (back)
1036(830)	Thread Take-up Crank Set Screw	62926	with 50305(803)	143085	Stitch Regulator
1036(830)	Feed Eccentric Body Set Screw (2)	64519	Needle Bar Bushing (lower) Thread	143086	Stitch Regulator Locking Slide
1053(805)	Rotating Hook Thread Guard Screw (4)	125320	Eyelet	143087	Stitch Regulator Locking Slide
1133(830)	Presser Bar Bushing (lower) Set	140036(803)	Arm Spool Pin and Thread Eyelet	143088	Ratchet Wheel
	Screw	140228(805)	Thread Take-up Spring		Stitch Regulator Locking Slide
1133(830)	Needle Bar Bushing (upper) Set Screw	140228(805)	Thread Retainer	143104	Ratchet Wheel Pin
1133(830)	Needle Bar Bushing (lower) Set Screw	140230(803)	Presser Bar Lifting Lever Connecting	143109	Bell Crank Hinge Pin
1253(830)	Rotating Hook Set Screw (2)	140231(803)	Rod Lock Nut		Presser Bar Lifting Lever Connecting
1259(830)	Arm Shaft (upright) Bevel Gear	140231(803)	Presser Bar Lifting Lever Connecting	143124	Rod Swivel
	(upper) Set Screw (2)	140232(819)	Rod Nut	143125	Oil Pipe Clamping Sleeve
1259(830)	Arm Shaft (upright) Bevel Gear	140232(819)	Presser Foot Hinge Pin	143125	Oil Pipe Clamping Sleeve Nut
	(lower) Set Screw (2)	140239(830)	Presser Foot Shank	143126	Oil Pipe Clamping Sleeve Nut Adaptor
1259(830)	Rotating Hook Shaft Bevel Gear Set	140257(830)	Arm Top Cover Stitch Regulator	143134	Stitch Regulator 143085 with
	Screw (2)	140279(830)	Plunger Spring	140549(805), 143086 and 143378	140549(805), 143086 and 143378
1259(830)	Feed Lifting Eccentric Set Screw	140296(830)	Rotating Hook Bobbin Case Latch	143176	Trademark Rivet (2)
1285(830)	Rotating Hook Shaft Bushing (front)	140297(830)	Lever	143176	Number Plate Rivet (2)
	Set Screw	140333(830)	Needle Bar Thread Guard Screw	143191	Presser Bar Lifting Lever Connecting
1285(830)	Rotating Hook Shaft Bushing (back)	140343(805)	Feed Lifting Rock Shaft Crank (back)	143196	Rod Oil Mist Retaining Disc (felt)
	Set Screw		Clamping Screw	143236	Needle Bar Oil Wick
1367(805)	Rotating Hook Section Screw (3)	140228(805)	Feed Rock Shaft Crank Clamping	143236	Feed Rock Shaft Oil Screw Plug
1375(830)	Feed Eccentric Body Position Screw	140230(803)	Screw		Washer (fiber)
1380(805)	Rotating Hook Bobbin Case Tension	140230(830)	Feed Rock Shaft Connecting Rod Hinge	143236	Feed Lifting Rock Shaft Oil Screw
	Spring Screw	140231(803)	Screw		Plug Washer (fiber)
1423(803)	Feed Bar Connecting Link Cap	140231(803)	Feed Lifting Rock Shaft Connecting	143244	Arm Top Cover Spool Pin with Spool
	Screw (2)	140232(819)	Rod Hinge Screw		Rest, 3-1/2 in. long
1518(809)	Feed Rock Shaft Connecting Rod	140239(830)	Needle Bar Connecting Link Cap	143257	Machine Base and Oil Reservoir
	Hinge Screw Nut	140257(830)	Screw		Gasket (cork)
1518(809)	Feed Lifting Rock Shaft Connecting	140279(830)	Oil Wick Holder Screw	143268-001	Bed Leg (back)
	Rod Hinge Screw Nut	140296(830)	Needle Set Screw	143280-001	Rock Shaft
1560(803)	Tension Regulating Thumb Nut Lock	140297(830)	Feed Eccentric Stop Screw (5-1/2	143282	Adjusting Screw 140350(830) with
	Nut	140333(830)	at)ch)		51649(809)
1560(803)	Tension Regulating Thumb Nut	140343(805)	Arm Shaft (horizontal) Flanged	143295	Pair of Gears for Lower Shaft, Nos.
2070	Presser Bar Spring Washer		Bushing (front) Set Screw	143301-001	143014 and 143081 (for Agents only)
2102	Tension Disc (2)		Arm Shaft (horizontal) Bushing	143326	Rotating Hook Oil Wick (felt)
2974	Rotating Hook Bobbin Case Latch		(center) Set Screw		Needle Bar Connecting Stud with
	Lever Fulcrum Pin		Arm Shaft (horizontal) Flanged	140706(803)	140706(803)
2975	Rotating Hook Bobbin Case Latch		Bushing (back) Set Screw	143349-001	Rotating Hook Shaft Oil Filter Wick
	Spring		Feed Lifting Eccentric Position Screw		Holder
4307	Bed Slide Spring		Machine and Machine Base and Oil	143351	Rotating Hook Wiper
8582	Arm Dowel Pin (2)		Reservoir Screw Hole Plug Screw	143370	Oil Lead
8879	Arm Spool Pin Washer (cloth)		(for Agents only)	143373	Bell Crank
12329	Tension Releasing Lever Spring		Rock Shaft Crank Adjusting Screw	143374	Bell Crank Bracket
12398	Tension Releasing Lever Hinge Pin		Feed Rock Shaft Oil Screw Plug	143375	Bell Crank complete, Nos. 143104,
12431(819)	Bed Slide (for Agents only)		Feed Lifting Rock Shaft Oil Screw		143373 and 143374 (for Agents only)
12432	Bed Slide complete, Nos. 4307,		Plug	143378	Stitch Regulator Locking Slide Spring
	12431(819) and two 725(819), (for		Presser Foot Screw	143383	Rotating Hook Oil Flow Regulating
	Agents only)		Needle Bar Crank Position Screw		Thumb Screw Spring
12990	Needle Bar Bushing (upper)		Stitch Regulator Locking Slide Spring	143384	Oil Pipe (for oiling Rotating Hook
13288	Arm Top Cover Stitch Regulator		Screw		Shaft (front) Bearing)
	Plunger Spring Stop Ring		Oil Removing Wick (head end) Holder		
13996	Feed Rock Shaft Oil Wick		Body Hinge Screw		

IT NO.	DESCRIPTION	PART NO.	DESCRIPTION
1387	Oil Pipe 143384 with 143124 (for oiling Rotating Hook Shaft Front Bearing (for Agents only)	147160	Tension Releasing Lever (adjustable) 147159 with 50123(819) and 147161
1099	Feed Rock Shaft Crank with 140228(805)	147161 147166 147250	Tension Releasing Lever Segment Slack Thread Regulator Presser Bar Lifting Lever Pin
1552	Arm Screw (front and intermediate) (2)	147290	Feed Lifting Rock Shaft Crank (front) with 140915(830)
1591	Oil Flow Body	147291	Presser Bar Spring
1610	Presser Bar Lifting Lever Spring	147292	Tension Stud 140873(803) with two 1560(803)
1698	Oil Removing Wick (head end) Holder Body Spring	147293	Tension complete, Nos. 32574, 52083, 52394, 147151, 147152, 147292 and two 2102 (for Agents only)
1745	Oil Removing Wick (head end) Holder Body	147296	Thread Take-up Lever Oil Guard with 143196 and 147053
1790	Arm Shaft (horizontal) Flanged Bushing (back) Oil Sump Tube	147355	Feed Bar Carrier with two each 158(805) and 140788(805)
1005-001	Arm Shaft (horizontal) Flanged Bushing (front)	147356 147445	Feed Bar Hinge Pin (eccentric) Presser Bar Lifting Lever with 454(830)
1011	Arm Top Cover for 147013	147468	Arm Shaft (horizontal) Thrust Collar with two 624(830)
1012	Arm Top Cover for 147014	147469	Combination of Feed and Stitch Regulator Parts, Nos. 143015, 143040, 143049, 143087, 143134, 147472-002 and 143473 (for Agents only)
1013	Arm Top Cover with Stitch Regulator Plunger complete, Nos. 13288, 64519, 147011 and 147105	147470 147471	Feed Bar Feed Bar 147470 with 21478, 147290, 147355, 147356 and two 1423(803)
1014	Arm Top Cover with Stitch Regulator Plunger complete, when a longer spool pin (3-1/2 in. long) is required, Nos. 13288, 64519, 143244, 147012 and 147105	147472-002 147473	Feed Eccentric Feed Lifting Eccentric and Arm Shaft (horizontal) Bevel Gear, right hand spiral with 1259(830), 140133(830) and 143088
1015	Arm Top Cover Gasket	147476	Pair of Gears, for Upper Shaft, Nos. 143015 and 147473 (for Agents only)
1019	Face Plate Gasket	147480 147481	Bell Crank Plunger Rock Shaft 143280 with 147482-001, 147483 and 147485
1024	Feed Bar Carrier Oil Wick Holder with 143031	147482-001	Rock Shaft Crank with 141253(830) and 143282
1025-001	Feed Lifting Rock Shaft	147483 147485 147491	Rock Shaft Stop Dog with 141253(830) Rock Shaft Spring Machine Base and Oil Reservoir
1029	Feed Rock Shaft Collar with two 460(830)	147292-002 149060 149061	Needle Bar Connecting Link Rotating Hook Bobbin Case Rotating Hook Bobbin Case 149060 with 591(806), 1380(805) and 40394
1029	Feed Lifting Rock Shaft Collar with two 460(830) (2)	149063	Rotating Hook Bobbin Case complete, Nos. 592(805), 2974, 2975, 40392, 125320 and 149061
1030-001	Feed Lifting Rock Shaft 147025-001 with 13996, 140359(805), 143236, 147038 and suitable length of No. 1229 White Lighter Wicking	149064 149065 149066 149074	Rotating Hook Bobbin Case Holder Rotating Hook Section Rotating Hook Thread Guard Feed Lifting Rock Shaft Crank (back) with 140228(805)
1037	Feed Lifting Rock Shaft Oil Wick (short) (for Agents only) (2)	149107	Presser Bar Guide Bracket with 50203(830)
1038	Feed Lifting Rock Shaft Oil Wick (long)	149111	Face Plate Plug, for plugging the Presser Bar Adjustment Hole
1040-001	Feed Rock Shaft	149112 149121	Face Plate with 149111 Machine Base and Oil Reservoir with Knee Lifter Rock Shaft
1041-001	Feed Rock Shaft 147040-001 with 13996, 140359(805), 143236, 147046 and suitable length of No. 1229 White Lighter Wicking	149124	Rotating Hook Bobbin Case Holder Position Bracket (for heavy thread use 149123)
1045	Feed Rock Shaft Oil Wick (short) (for Agents only) (2)	149131	Arm Shaft (horizontal) with 1036(830) and 140542(830)
1046	Feed Rock Shaft Oil Wick (long)	149133-002 149139 149141	Needle Bar (hollow) with 140239(830) Presser Bar (hollow) Rotating Hook (air cooled) with 143301-001 and two 1253(810)
1050-001	Needle Bar Connecting Link 147492-002 with 143326 (for Agents only)	149142 149145	Rotating Hook (air cooled) 149141 with 143351, 149066 and four 1053(805) Rotating Hook (air cooled) 149142 with 149065 and three 1367(805)
1053	Needle Bar Connecting Stud Oil Wick	149148 149149 149150-001 149152 149153	Rotating Hook Shaft with 149153 Rotating Hook Shaft 149148 with 147131 Rotating Hook Shaft Bushing (front) Rotating Hook Shaft Oil Filter Wick Rotating Hook Shaft Oil Filter complete, Nos. 143349-001 and 149152
1055	Oil Removing Wick (head end) Hinge Plate and Cover Gasket	149154	Thread Eyelet and Thread Guard (front of Arm)
1058	Presser Bar Bushing (lower)	149155	Thread Take-up Crank with Thread Take-up Lever, Nos. 149160 and eighteen 143056 (for Agents only)
1060	Presser Bar Lifter	149157-001	Thread Take-up Crank and Thread Take-up Lever complete, (for Agents only)
1070	Thread Take-up Clamping Screw Hole Plug Screw Gasket	149160	Thread Take-up Crank Wearing Plate
1073	Thread Take-up Lever Link Hinge Stud	149161 149172	Thread Take-up Lever Guard Rotating Hook (air cooled) 149142 with 149064, 149065 and three 1367(805)
1074	Thread Take-up Lever Link Hinge Stud Oil Wick	149173	Rotating Hook (air cooled) 149172 with 149063 and 149153 (for Agents only)
1075	Thread Take-up Lever Link Hinge Stud 147073 with 147074	149205	Oil Removing Wick (head end) Hinge Plate and Cover
1077	Thread Take-up Lever Guard Gasket	149206	Oil Removing Wick (head end) Holder Body complete, Nos. 140553(805), 146698, 146745, 147055, 147107 and 149205
1079	Thread Take-up Lever Thread Eyelet Bushing		
1085	Arm Side Shield		
1091	Pressure Regulating Thumb Screw and Presser Bar Guide		
1095	Arm Top Cover Stitch Regulator Plunger		
1096	Oil Pipe complete, (from Oil Pump to Arm Shaft (horizontal) Center Bearing), Nos. 143064, 143065 and 143066 (for Agents only)		
1097	Oil Removing Wick (head end)		
1098	Oil Removing Wick (head end) Holder Body 146745 with 146698 and 147107 (for Agents only)		
111-001	Arm Shaft (upright) Bushing (upper)		
112-001	Arm Shaft (horizontal) Flanged Bushing (back)		
131	Rotating Hook Shaft Oil Retaining Collar with two 50429(830)		
139	Machine Pulley, small rim diameter (disc power) 1/2" belt groove 2.9 in. diameter with two 51283(830)		
140	Machine Pulley, large rim diameter (disc power) 1/2" belt groove 2.9 in. diameter with two 51283(830)		
141	Oil Wick, 11 in. long, for oiling Take-up Lever, Take-up Lever Link, Needle Bar Connecting Link and Thread Take-up Lever Link Hinge Bearing		
143	Oil Wick Holder with two 147141		
151	Tension Releasing Disc		
152	Tension Spring		
158	Throat Plate (small needle hole) with Guide Lines, for 22634		
159	Tension Releasing Lever Body		

PART NO.	DESCRIPTION
149224	Oil Wick Holder Plug (felt)
149227	Presser Bar Bushing Washer
149235-003	Needle Bar Thread Guard
161065	Presser Foot Plate
161066	Presser Foot (spring hinged) complete, Nos. 62527, 62926, 161065 and 161160, for use with 22834 and 147158
161160	Presser Foot Spring
272152	Rotating Hook Bobbin

## ACCESSORIES

PART NO.	DESCRIPTION
259462	Bobbin Winder
151559	Machine Rest Pad (4)
12361	Machine Hinge Connection (2)
41400	Machine Rest Pin
147488	Rock Shaft Knee Arm complete
52239	Spool Pin and Thread Eyelet
8879	Washer (cloth)

## STYLE OF FINISH

When ordering screws, nuts and similar parts include new code numbers which follow part numbers in list.

NEW CODE	OLD CODE	FINISH
803	C	Hardened only
805	E	Soft, Not Polished
806	F	Hardened and Polished
809	J	Nickel Plated only
813	R	Phosphate Coating formed on Surface of Iron or Steel
819	X	Black Oxide for Iron and Steel
830	A. L.	Heat Treated for Toughness
850	X. C.	Hardened and Black Oxide for Iron and Steel

## MACHINES 281-3 AND 281-21

### MACHINE 281-3

Same as 281-1, except for the following:

PARTS ADDED	DESCRIPTION	PARTS REMOVED
147081	Arm Shaft (horizontal) with 1036(830), 140542(830) and 141208(830)	149131
22773	Arm Side Shield and Oil Wick Holder, Nos. 22768 and 147145	22777
143174	Feed Dog	22834
149220-002	Needle Bar (hollow) with 140239(830)	149133-002
21148-001	Needle Bar (hollow) complete, Nos. 140036(803), 149220-002 and 149235-003	21103-001
20798-001	Needle Bar Bushing (lower)	20798-002
147145	Oil Wick Holder with two 147141	147143
147057	Presser Bar (hollow)	149139
127233	Presser Foot Plate	161065
52390	Presser Foot Shank	62926
26231	Presser Foot Spring	161160
127234	Presser Foot (spring hinged) complete, Nos. 26231, 52390, 62527 and 127233	161066
149166	Thread Eyelet and Thread Guard (front of arm)	149154
149198-002	Thread Take-up Crank and Thread Take-up Lever complete, Nos. 147075 and 149197-002	149157-001
143175	Throat Plate	147158
149123	Rotating Hook Bobbin Case Holder Position Bracket, for Heavy Thread Note: 149123 is not regular to the machine, but is available on order.	--

### MACHINE 281-21

Same as 281-1, except for the following:

PARTS ADDED	DESCRIPTION	PARTS REMOVED
149167	Arm Shaft (horizontal) with 1036(830), 140542(830) and 141208(830)	149131
448(830)	Arm Shaft (horizontal) Flanged Bushing (front) Set Screw	140279(830)
147358-001	Feed Lifting Rock Shaft 14497 with 13996, 140359(805), 143236, 147038 and suitable length of No. 1229 White Lighter Wicking	147030-001
14497	Feed Lifting Rock Shaft	147025-001
14499	Feed Rock Shaft	147040-001
147359-001	Feed Rock Shaft 14499 with 13996, 140359(805), 143236, 147046 and suitable length of No. 1229 White Lighter Wicking	147041-001
149168	Needle Bar (hollow) with 140239(830)	149133-002
21398-001	Needle Bar (hollow) complete, Nos. 140036(803), 149168 and 149235-003	21103-001
147360	Oil Pipe for Oiling Rotating Hook Shaft (front) Bearing	143384
149213	Presser Bar Lifting Lever with 448(830)	147445
147062	Presser Bar Lifting Lever Pin	147250
448(830)	Presser Bar Lifting Lever Pin Set Screw	454(830)
50190(809)	Presser Foot-Thumb Screw	140370(830)
149169	Rotating Hook Shaft with 149153	149148
149171	Rotating Hook Shaft 149169 with 147131	149149
149123	Rotating Hook Bobbin Case Holder Position Bracket, for Heavy Thread Note: 149123 is not regular to the machine, but is available on order.	